

| LOC | DIST | REVISIONS | | | |
|-----|------|-------------|---------------|-----------|---------|
| GP | 00 | REV | DESCRIPTION | DATE | BY |
| E | | REVISED PER | ECO-12-021104 | 22JAN2013 | CJV/CWR |

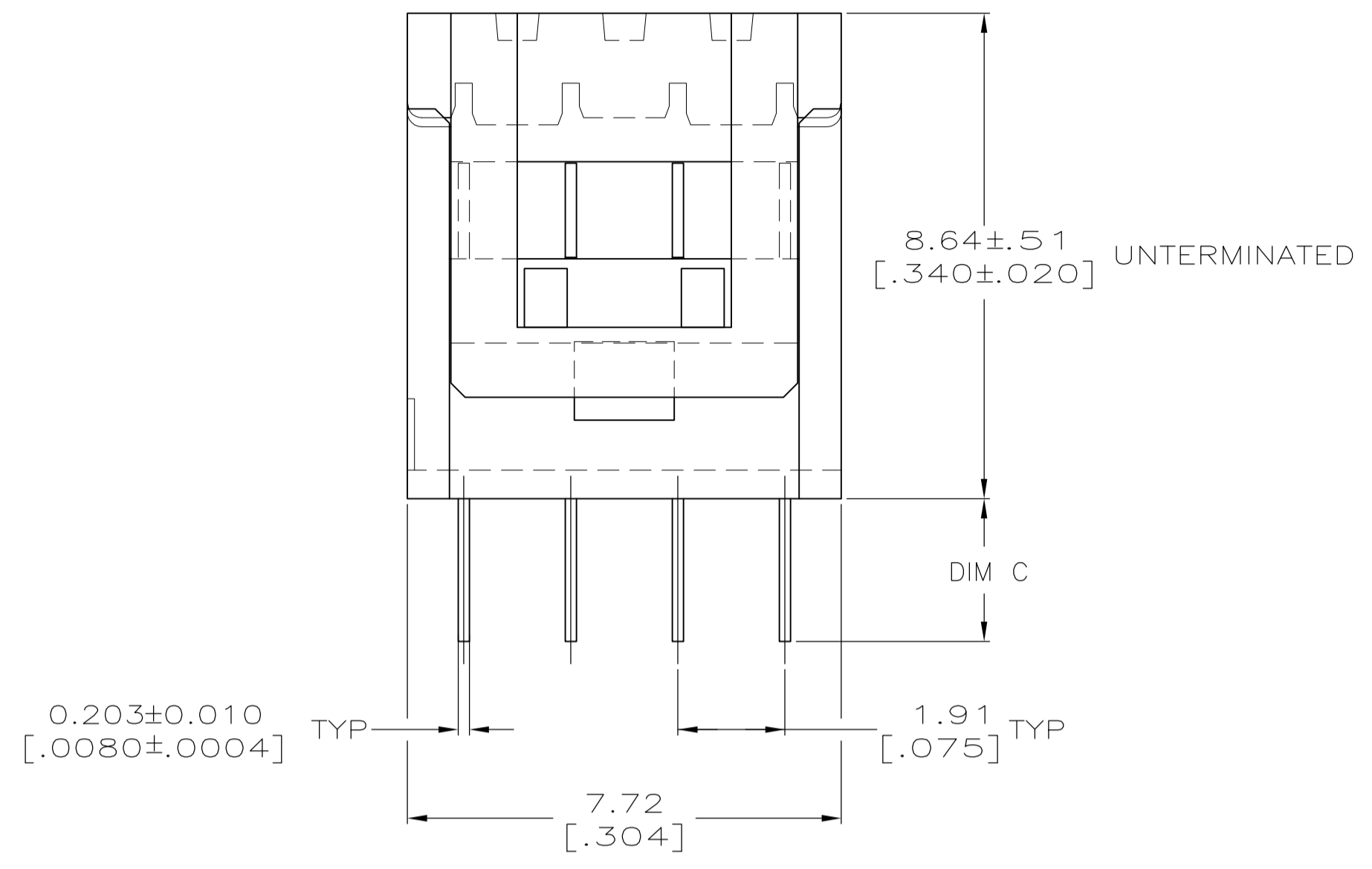

- △ HOUSING: UL RATED 94V-0 LCP THERMOPLASTIC, COLOR BLACK.
COVER: UL RATED 94V-0 POLYESTER MOLDING COMPOUND, COLOR BLACK.
- △ CONTACTS: COPPER ALLOY.
- △ CONTACTS: 0.00254 [.000100] MIN MATTE TIN OVER 0.00127 [.000050] MIN NICKEL.
- △ POSITION 1 INDICATOR, OMITTED FOR PART NUMBER 2-5111595-1.
- △ VOID CORES MAY OR MAY NOT BE PRESENT BETWEEN ANY 2 ROWS OF CONTACTS.

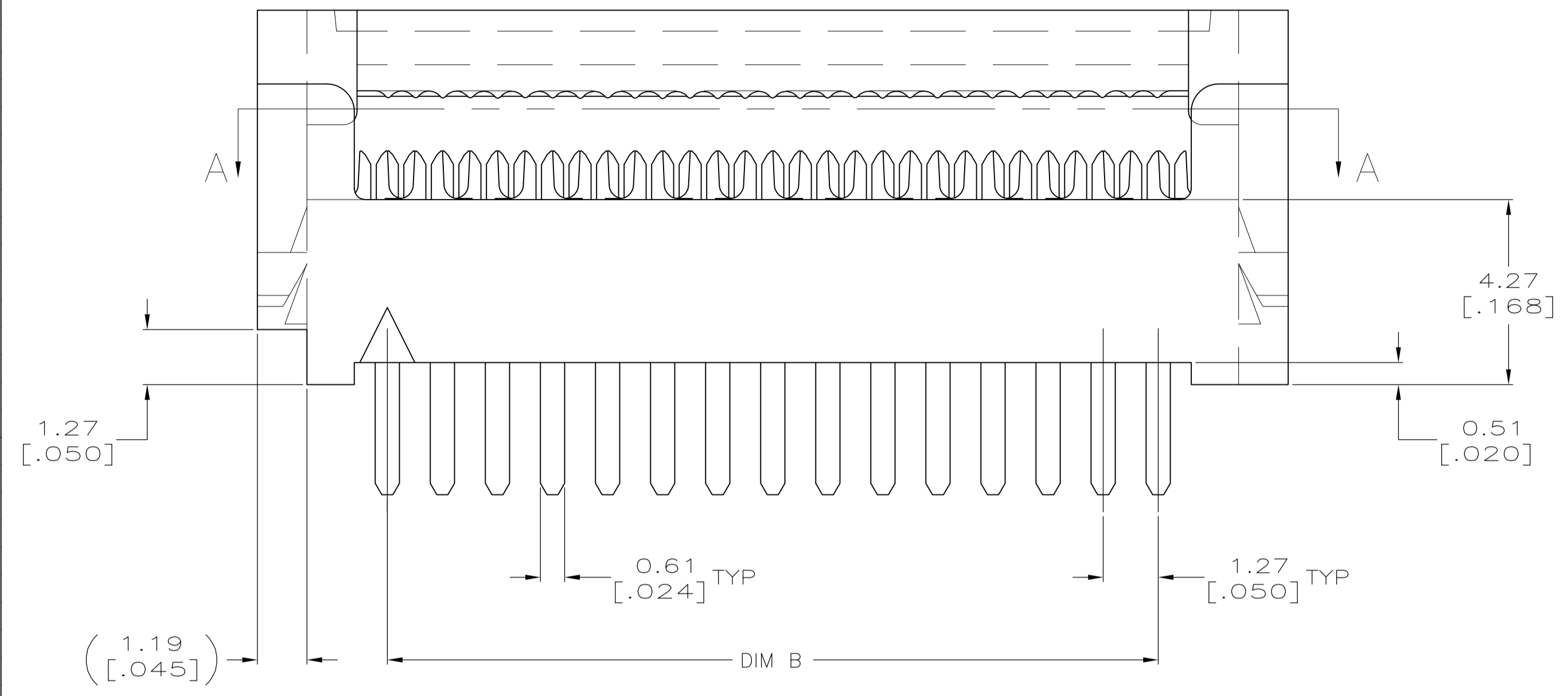
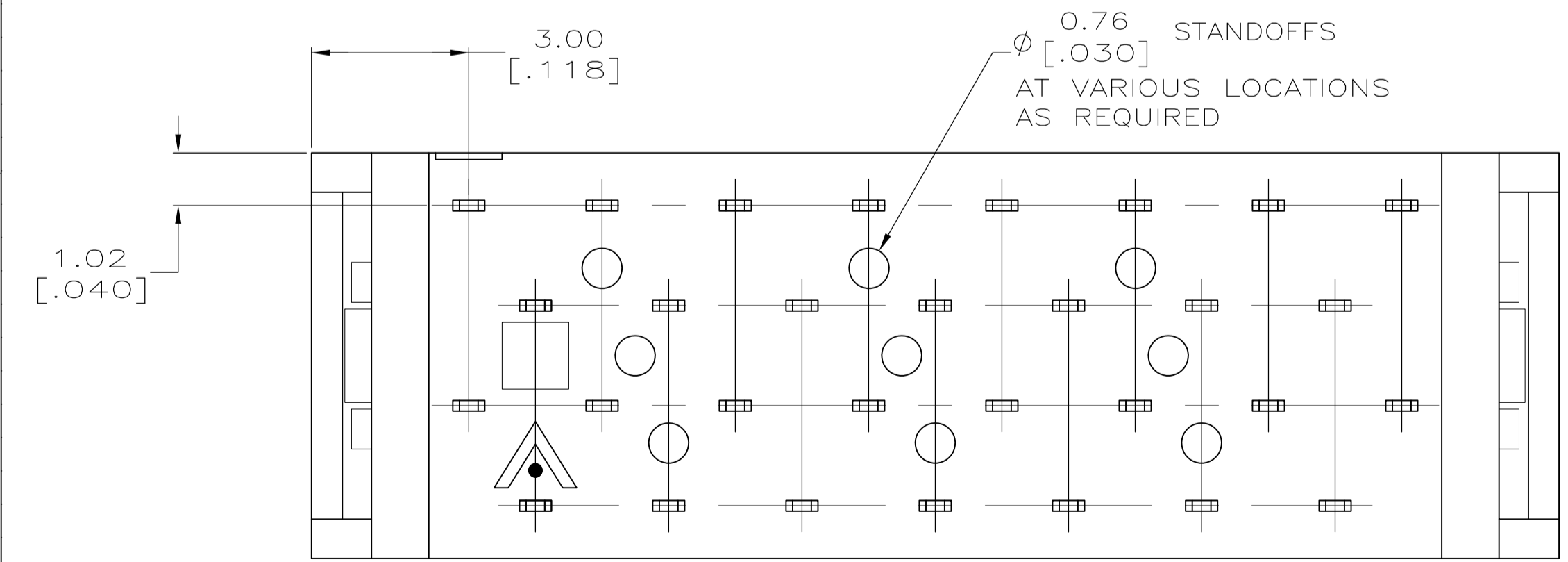
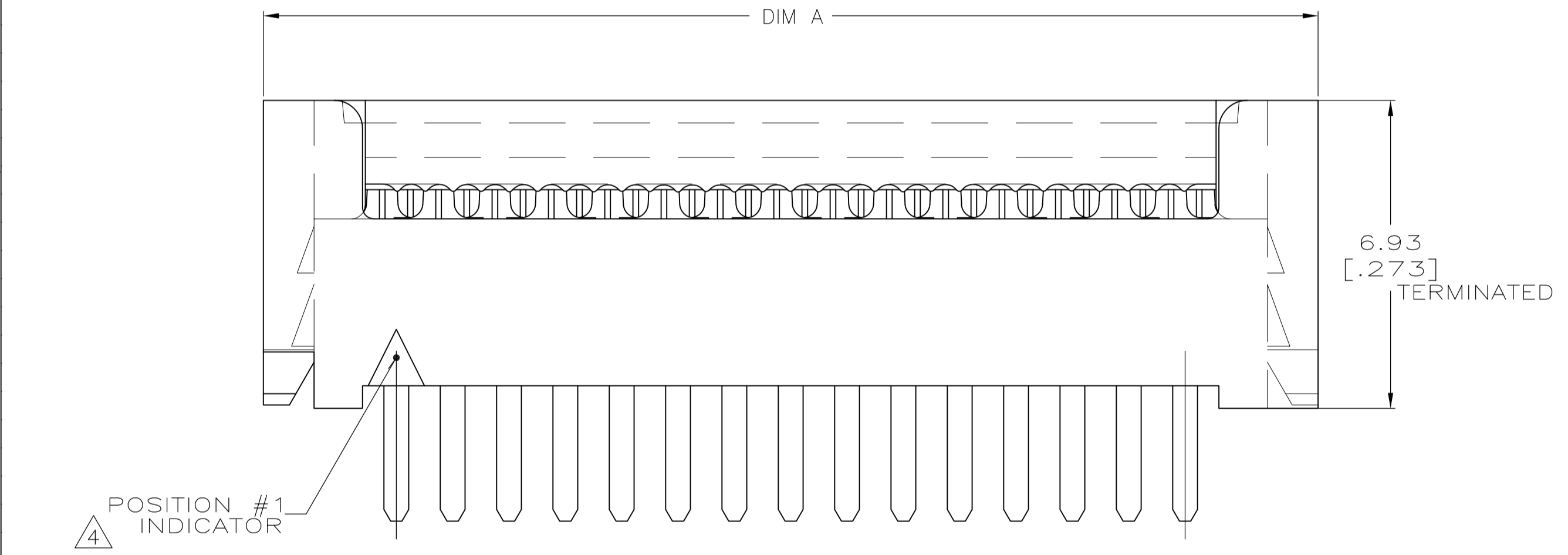

| PRELIMINARY | #1 | 3.30 [.130] | 30.48 [1.200] | 36.47 [1.436] | 50 | 2-5111595-5 |
|-------------|------------|-------------|---------------|---------------|------|---------------|
| | #1 | 3.30 [.130] | 5.08 [.200] | 11.07 [.436] | 10 | 2-5111595-4 |
| | #2 | 3.30 [.130] | 49.53 [1.950] | 55.52 [2.186] | 80 | 2-5111595-2 △ |
| | #2 | 2.54 [.100] | 41.91 [1.650] | 47.90 [1.886] | 68 | 2-5111595-1 |
| | #2 | 2.54 [.100] | 16.51 [.650] | 22.50 [.886] | 28 | 2-5111595-0 |
| | #2 | 2.54 [.100] | 41.91 [1.650] | 47.90 [1.886] | 68 | 1-5111595-9 |
| | #1 | 2.54 [.100] | 27.94 [1.100] | 33.93 [1.336] | 46 | 1-5111595-7 |
| | #2 | 2.54 [.100] | 62.23 [2.450] | 68.22 [2.686] | 100 | 1-5111595-6 |
| | #2 | 2.54 [.100] | 49.53 [1.950] | 55.52 [2.186] | 80 | 1-5111595-5 |
| | #2 | 2.54 [.100] | 44.45 [1.750] | 50.44 [1.986] | 72 | 1-5111595-4 |
| | #2 | 2.54 [.100] | 39.37 [1.550] | 45.36 [1.786] | 64 | 1-5111595-3 |
| | #2 | 2.54 [.100] | 36.83 [1.450] | 42.82 [1.686] | 60 | 1-5111595-2 |
| | #1 | 2.54 [.100] | 30.48 [1.200] | 36.47 [1.436] | 50 | 1-5111595-1 |
| | #2 | 2.54 [.100] | 26.67 [1.050] | 32.66 [1.286] | 44 | 1-5111595-0 |
| | #2 | 2.54 [.100] | 24.13 [.950] | 30.12 [1.186] | 40 | 5111595-9 |
| | #1 | 2.54 [.100] | 20.32 [.800] | 26.31 [1.036] | 34 | 5111595-8 |
| | #1 | 2.54 [.100] | 17.78 [.700] | 23.77 [.936] | 30 | 5111595-7 |
| | #1 | 2.54 [.100] | 15.24 [.600] | 21.23 [.836] | 26 | 5111595-6 |
| | #2 | 2.54 [.100] | 13.97 [.550] | 19.96 [.786] | 24 | 5111595-5 |
| | #2 | 2.54 [.100] | 11.43 [.450] | 17.42 [.686] | 20 | 5111595-4 |
| | #2 | 2.54 [.100] | 8.89 [.350] | 14.88 [.586] | 16 | 5111595-3 |
| | #1 | 2.54 [.100] | 7.62 [.300] | 13.61 [.536] | 14 | 5111595-2 |
| | #1 | 2.54 [.100] | 5.08 [.200] | 11.07 [.436] | 10 | 5111595-1 |
| | PCB LAYOUT | C | B | A | POSN | PART NO |

THIS DRAWING IS A CONTROLLED DOCUMENT. DIMENSIONING AND TOLERANCING PER ASME Y14.5M-2009.

| | | | |
|-------------------------|--|----------------------------|-----------------|
| DIMENSIONS: mm [INCHES] | TOLERANCES UNLESS OTHERWISE SPECIFIED: | DWG: G. ATTADIA - 11-26-04 | DOCKS: 11-26-04 |
| 0. PLC ± - | 1. PLC ± - | C. RÖHDE | |
| 2. PLC ± - | 3. PLC ± .13 [.005] | M. WALMSLEY | |
| 4. PLC ± - | ANGLES ± - | | |

MATERIAL: △△△ FINISH: △

STE TE Connectivity

AMPMODU® SYSTEM 50, CONNECTOR, PADDLEBOARD

108-1109

114-25040

00779 5111595

CUSTOMER DRAWING SCALE 10:1 SHEET 1 OF 2 REV E

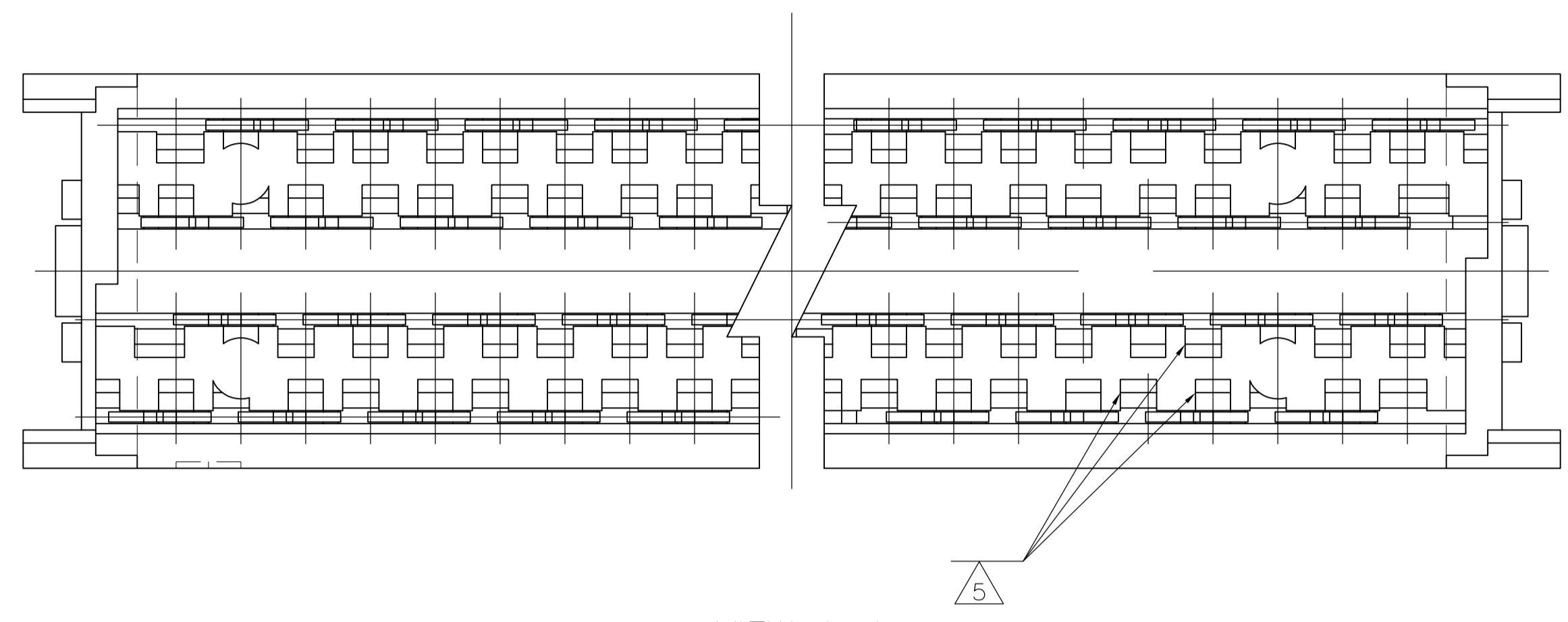

VIEW A-A
(COVER REMOVED FOR CLARITY)

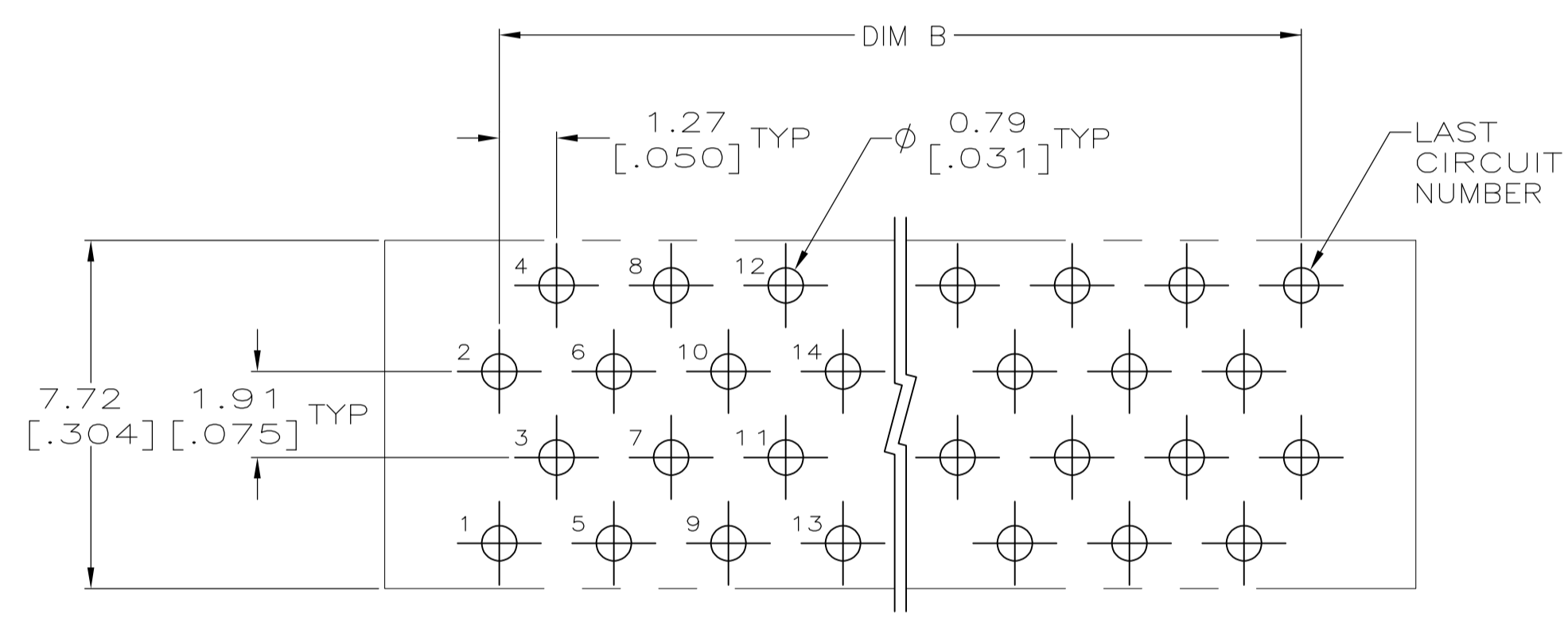

PRINTED CIRCUIT BOARD HOLE LAYOUT #2

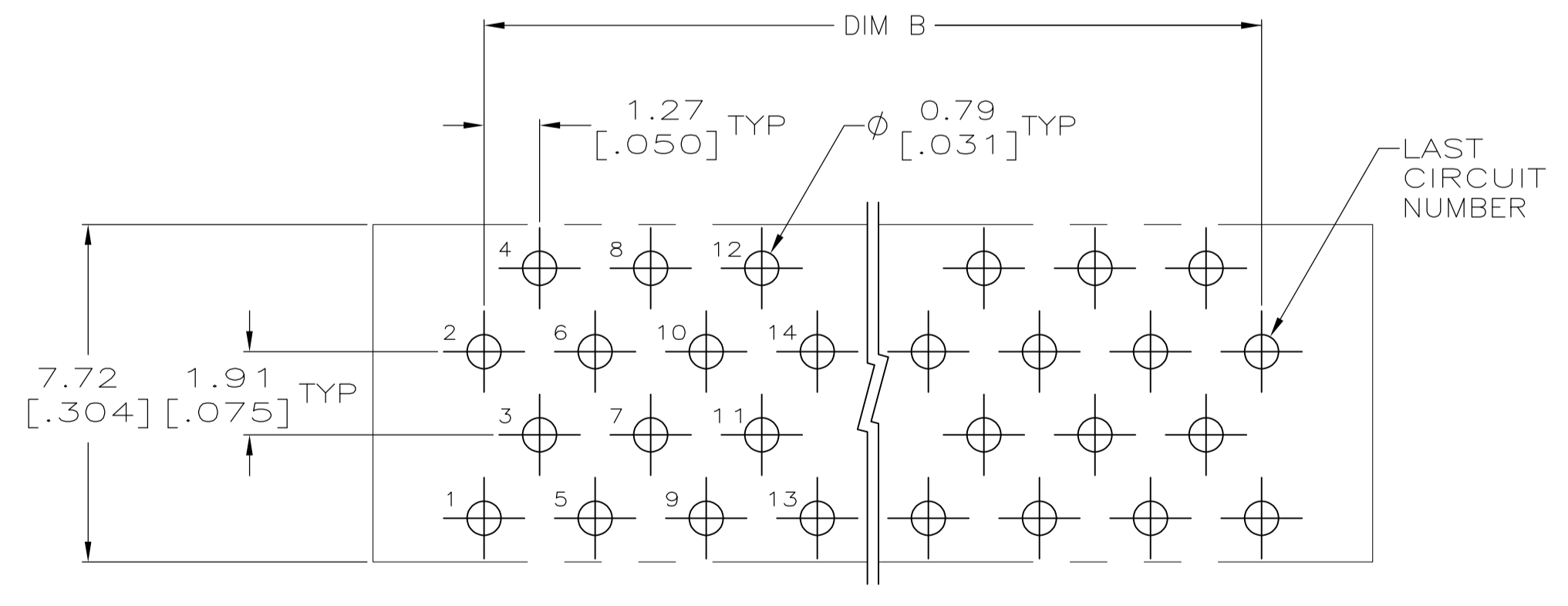

PRINTED CIRCUIT BOARD HOLE LAYOUT #1

| | | | |
|--|-----------------------|--------------------------------|--|
| THIS DRAWING IS A CONTROLLED DOCUMENT. DIMENSIONING AND TOLERANCING PER ASME Y14.5M-2009 | | DIN G. ATTADIA 26NOV04 | TE Connectivity |
| DIMENSIONS: mm [INCHES] | | CJK C. ROHDE 26NOV04 | |
| TOLERANCES UNLESS OTHERWISE SPECIFIED: | | APVD M. WALMSLEY 26NOV04 | NAME AMPMODU SYSTEM 50, CONNECTOR, PADDLEBOARD |
| <ul style="list-style-type: none"> 0. PLC ± - 1. PLC ± - 2. PLC ± - 3. PLC ± - 4. PLC ± - ANGLES ± - | | APPLICATION SPEC | RESTRICTED TO |
| MATERIAL SEE SHEET 1 | FINISH SEE SHEET 1 | WEIGHT - | SIZE A1 |
| CUSTOMER DRAWING | | SCALE 10:1 | SHEET 2 OF 2 |
| | | DRAWING NO. 00779 | REV E |
| | | C=5111595 | |